

Fire Safety for Apartment Buildings

People living in an apartment building need to think ahead and be prepared in the event of a fire. It is important to know the fire safety features in your building and work together with neighbors to help keep the building as fire-safe as possible.

Safety Tips

- ✓ Use a portable fire extinguisher when the fire is confined to a small area, such as a wastebasket, and is not growing; everyone has exited the building; the fire department has been called or is being called; and the room is not filled with smoke.
- ✓ For the home, select a multi-purpose extinguisher (can be used on all types of home fires) that is large enough to put out a small fire, but not so heavy as to be difficult to handle.
- ✓ Read the instructions that come with the fire extinguisher and become familiar with its parts and operation before a fire breaks out. Ramsey fire offer hands-on fire extinguisher trainings.
- ✓ Install fire extinguishers close to an exit and keep your back to a clear exit when you use the device so you can make an easy escape if the fire cannot be controlled. If the room fills with smoke, leave immediately.
- ✓ Know when to go. Fire extinguishers are one element of a fire response plan, but the primary element is safe escape. Every household should have a home fire escape plan and working smoke alarms.
- ✓ Most fire extinguishers are emptied in less than a minute.



Fire Extinguisher Use - **PASS**

Be sure to remember the **PASS** operating technique for fire extinguishers. **PASS** stands for:

- P** - Pull the pin. Pulling the pin unlocks the operating lever or button so you can discharge the extinguisher. Stand at least 6 to 8 feet from the fire.
- A** - Aim low, pointing the extinguisher nozzle or hose at the base of the fire.
- S** - Squeeze the lever below the handle. Squeezing the lever discharges the contents of the extinguisher. When you release the lever, the discharge stops. Some models have a button to press rather than a lever.
- S** - Moving carefully toward the fire, keep the extinguisher aimed at the base of the fire and sweep from side to side until the flames appear to be out.

Watch the area. If the **fire** starts up again, repeat the **PASS** technique

To operate an extinguisher:

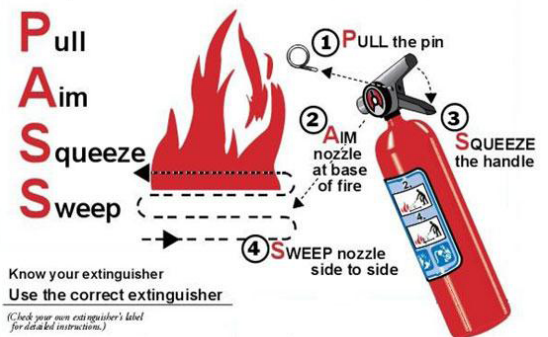

Ramsey Fire Prevention Bureau

Sunwood Drive NW, Ramsey, MN 55303
(763) 427-4452

